

Potential Drop Kerb Crossing to Bus Stop, exact location to be agreed with ECC

Potential Drop Kerb Crossing Points

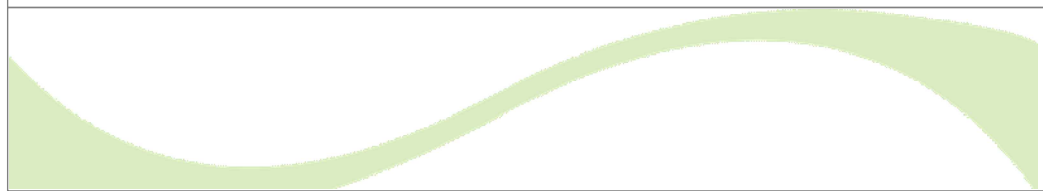

client: Marden Homes	title: Kelvedon Road Proposed Pedestrian Access Improvements with Crossing Points	date: 27/07/2021	scale @ A3 1:200
project: Kelvedon Road Tiptree	status: Planning (not for construction)	drawn	Revision
discipline: Transport Planning	project no: JTP 472	chk'd: SAA	dwg no: DR13

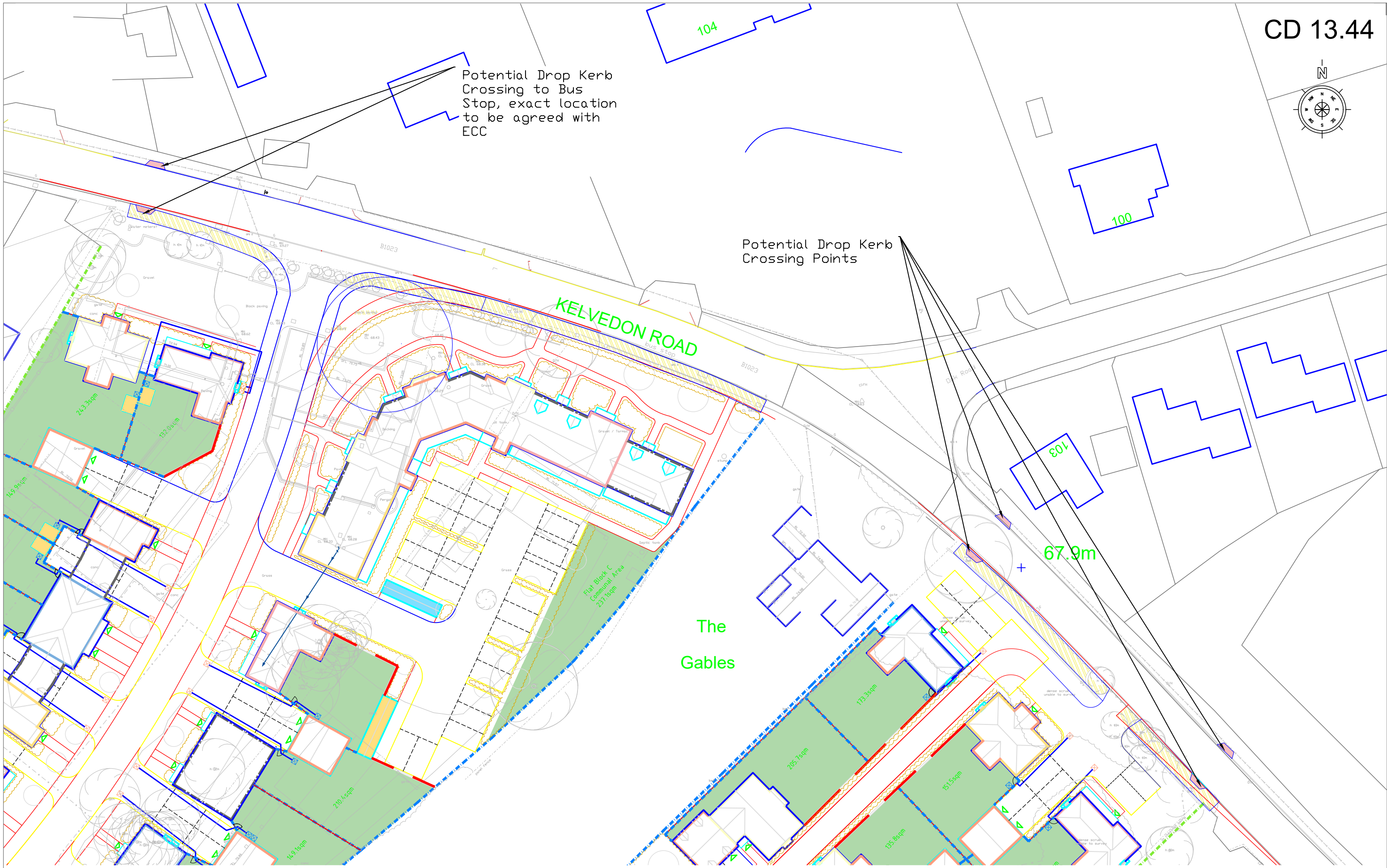