

Hatching denotes highway extent

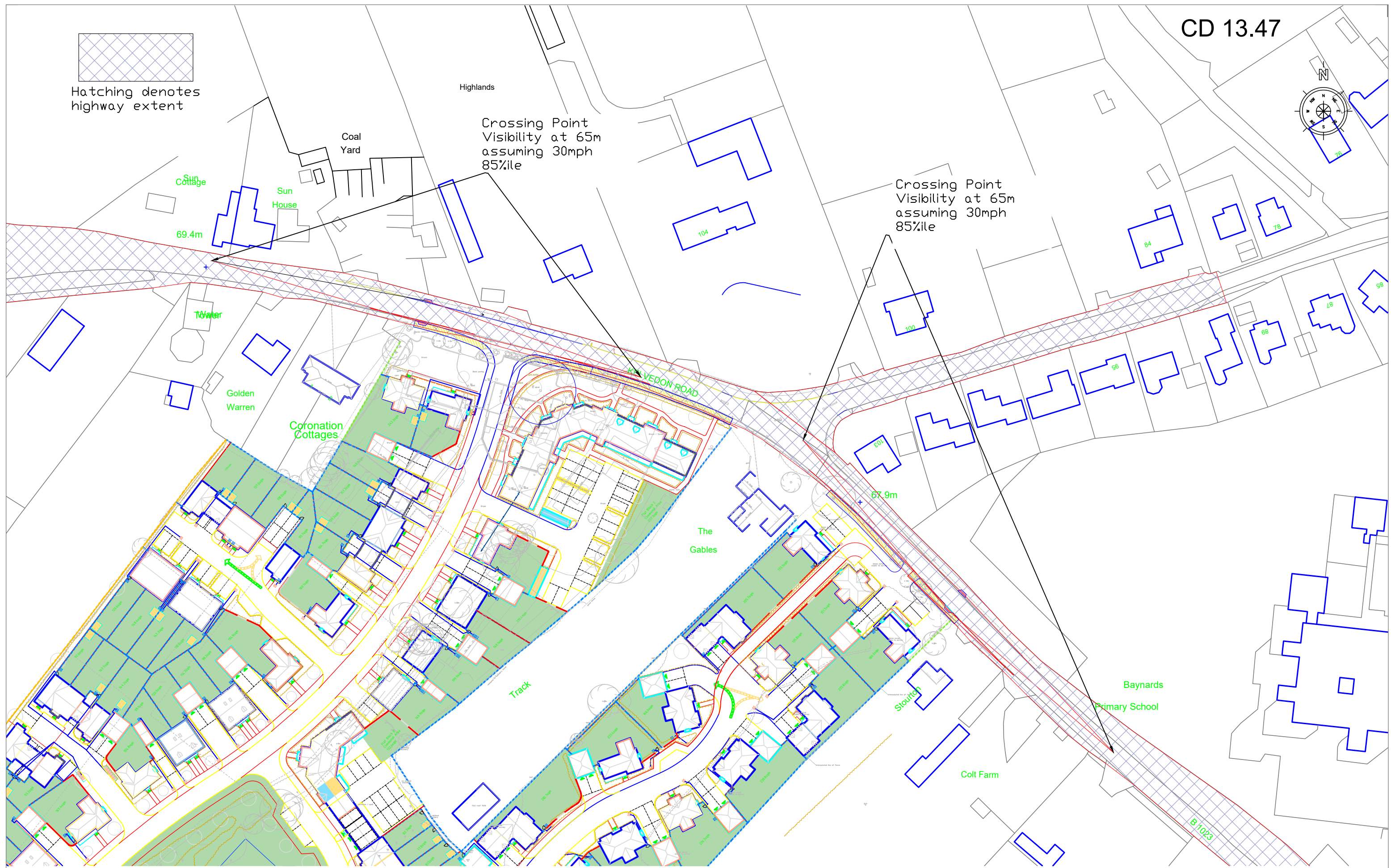

client: Marden Homes

project: Kelvedon Road Tiptree

discipline: Transport Planning

title: Kelvedon Road Proposed Pedestrian Access Improvements with Crossing Points Visibility

status: Planning (not for construction)

project no.: JTP 472

date: 27/07/2021

drawn

chk'd

SAA

scale @ A3  
1:1000

Revision

a

dwg no.

DR16

