

Title Number : EX822815

This title is dealt with by HM Land Registry, Peterborough Office.

The following extract contains information taken from the register of the above title number. A full copy of the register accompanies this document and you should read that in order to be sure that these brief details are complete.

Neither this extract nor the full copy is an 'Official Copy' of the register. An official copy of the register is admissible in evidence in a court to the same extent as the original. A person is entitled to be indemnified by the registrar if he or she suffers loss by reason of a mistake in an official copy.

This extract shows information current on 12 MAR 2020 at 16:49:29 and so does not take account of any application made after that time even if pending in HM Land Registry when this extract was issued.

REGISTER EXTRACT

Title Number	: EX822815
Address of Property	: The Paddock, Kelvedon Road, Tiptree, Colchester (CO5 0LU)
Price Stated	: £115,000
Registered Owner(s)	: NELSON TAYLOR of The Paddock, Kelvedon Road, Tiptree, Colchester, Essex CO5 0LU.
Lender(s)	: None

Title number EX822815

This is a copy of the register of the title number set out immediately below, showing the entries in the register on 12 MAR 2020 at 16:49:29. This copy does not take account of any application made after that time even if still pending in HM Land Registry when this copy was issued.

This copy is not an 'Official Copy' of the register. An official copy of the register is admissible in evidence in a court to the same extent as the original. A person is entitled to be indemnified by the registrar if he or she suffers loss by reason of a mistake in an official copy. If you want to obtain an official copy, the HM Land Registry web site explains how to do this.

## A: Property Register

This register describes the land and estate comprised in the title.

ESSEX : COLCHESTER

- 1 (25.04.2000) The Freehold land shown edged with red on the plan of the above title filed at the Registry and being The Paddock, Kelvedon Road, Tiptree, Colchester (CO5 0LU).
- 2 (06.10.2008) The land has the benefit of the rights granted by but is subject to the rights reserved by a Transfer of the land in this title dated 22 September 2008 made between (1) Nelson Taylor and others and (2) Nelson Taylor.

*NOTE:-Copy filed.*

- 3 (06.10.2008) The Transfer dated 22 September 2008 referred to above contains a provision relating to the creation of easements as therein mentioned.

## B: Proprietorship Register

This register specifies the class of title and identifies the owner. It contains any entries that affect the right of disposal.

Title absolute

- 1 (06.10.2008) PROPRIETOR: NELSON TAYLOR of The Paddock, Kelvedon Road, Tiptree, Colchester, Essex CO5 0LU.
- 2 (06.10.2008) The value stated as at 6 October 2008 was £115,000.

End of register

# HM Land Registry Current title plan

Title number **EX822815**  
Ordnance Survey map reference **TL8816NE**  
Scale **1:1250 enlarged from 1:2500**  
Administrative area **Essex : Colchester**

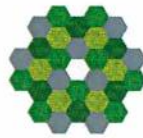

© Crown Copyright. Produced by HM Land Registry. Reproduction in whole or in part is prohibited without the prior written permission of Ordnance Survey. Licence Number 100026316

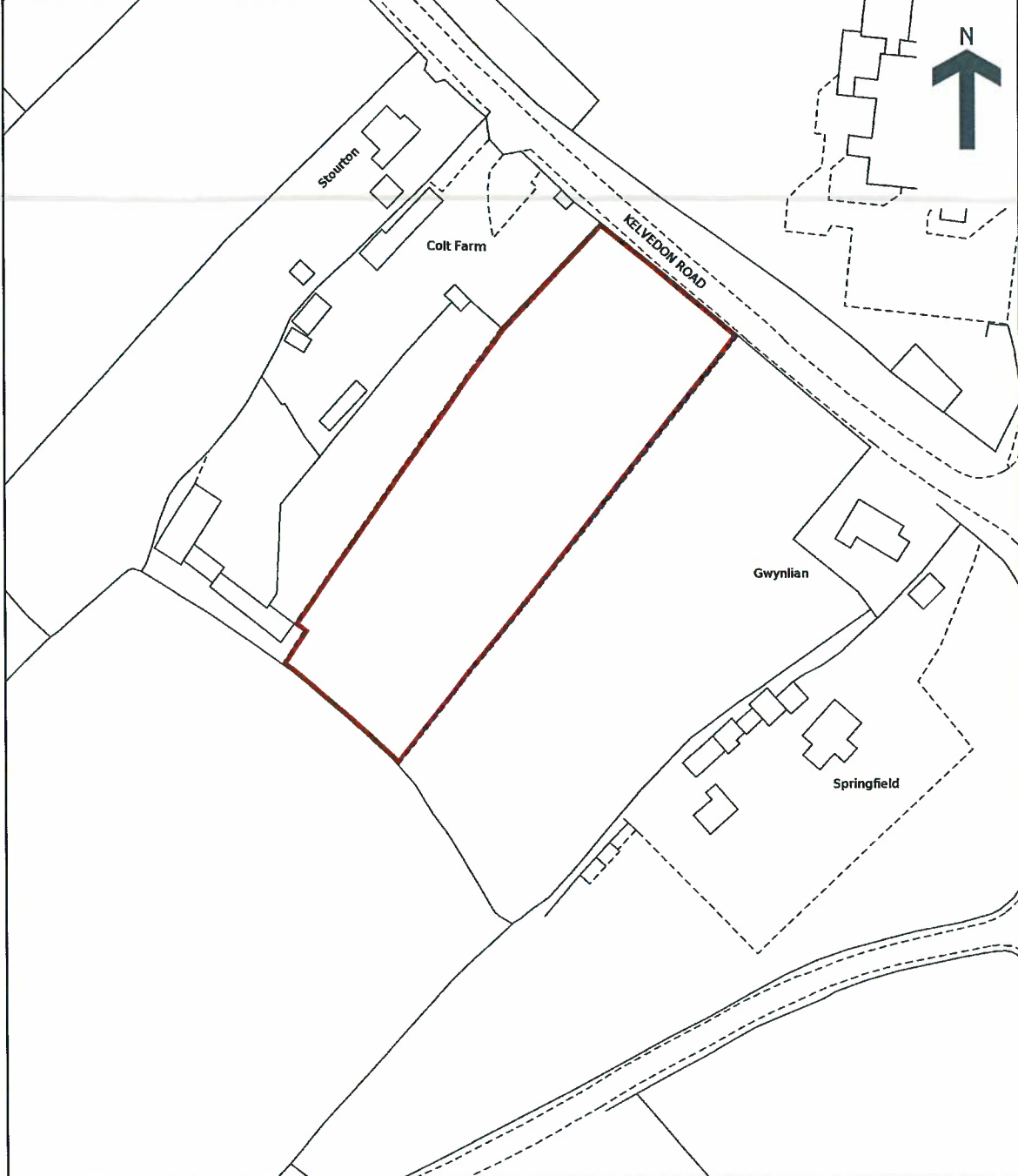

**This is a copy of the title plan on 12 MAR 2020 at 16:49:30. This copy does not take account of any application made after that time even if still pending in HM Land Registry when this copy was issued.**

**This copy is not an 'Official Copy' of the title plan. An official copy of the title plan is admissible in evidence in a court to the same extent as the original. A person is entitled to be indemnified by the registrar if he or she suffers loss by reason of a mistake in an official copy. If you want to obtain an official copy, the HM Land Registry web site explains how to do this.**

**HM Land Registry endeavours to maintain high quality and scale accuracy of title plan images. The quality and accuracy of any print will depend on your printer, your computer and its print settings. This title plan shows the general position, not the exact line, of the boundaries. It may be subject to distortions in scale. Measurements scaled from this plan may not match measurements between the same points on the ground.**

**This title is dealt with by HM Land Registry, Peterborough Office.**