







Key

-  Extent of Highway Controlled Land interpolated from ECC Ownership Plan
-  Visibility Splay for Site Access
-  Site Boundary
-  Visibility Splay for Property 104a

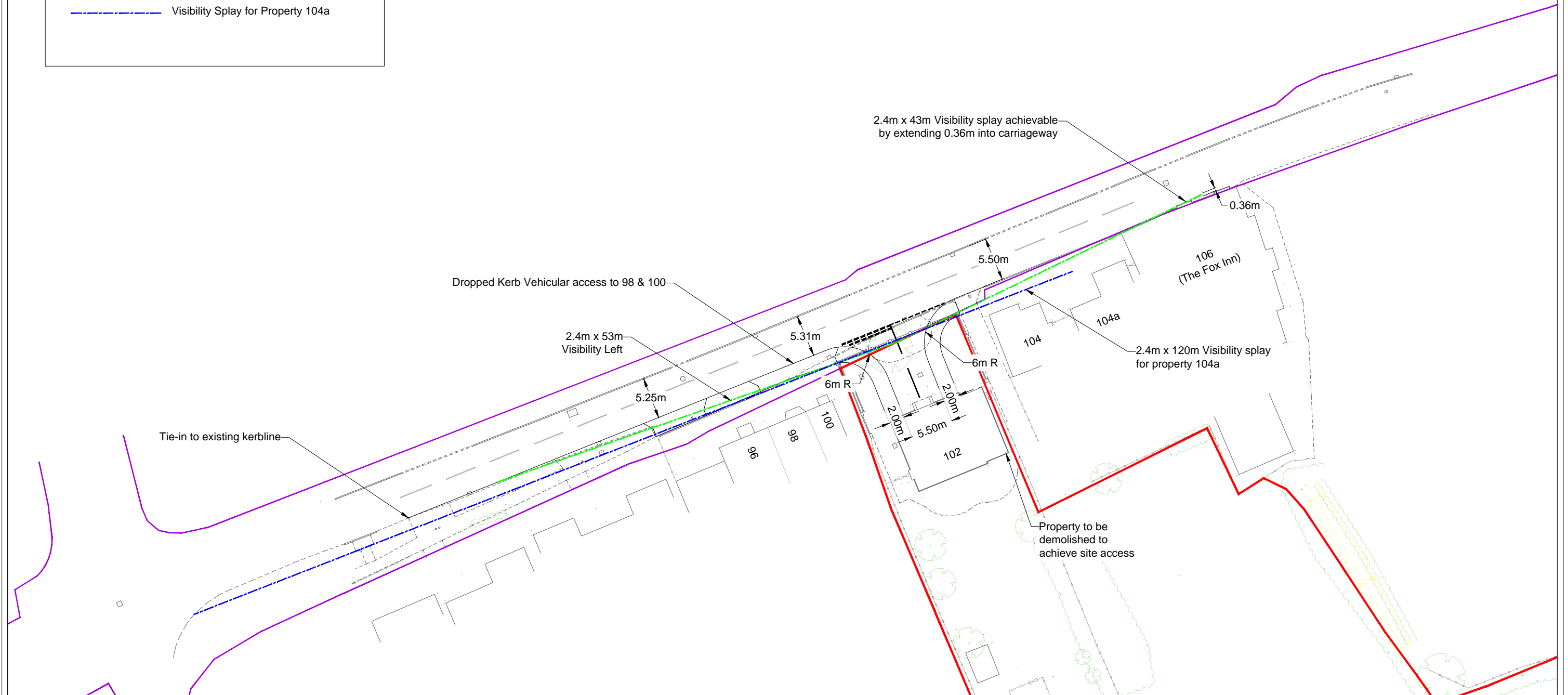

Drawing Title: SITE ACCESS JUNCTION ARRANGEMENT		Rev: A	
IT Project: 102 EAST ROAD, WEST MERSEA		Drawing No: IT2211/SK/001	
Date: DEC 2020		CAD File: IT2211_SK R1.dwg	
Client: JOHNSON DENNEHY PLANNING PARTNERSHIP		Date: DEC 2020	
Drawn By: MK		Scale: 1:500	
Approved By: SW		Date: 21.10.21	
A3		Notes: Dimensions should not be scaled from this drawing. The contents of this drawing are confidential, should you receive this drawing in error please return it to Intermodal Transportation at the address printed.	
		Reproduced from Ordnance Survey Supermap Data Crown copyright (2020) All rights reserved. License No: 100033662	



Intermodal TRANSPORTATION

Hunters Court
Debden road
Saffron Walden
Essex CB11 4AA

Tel: +44 (0)1799 529529
e: enquiries@inter-modal.co.uk

Sheet 1 of 1